



AIRPORT CONNECTION



AIRPORT MASTER PLAN UPDATE

The Airport has received FAA Approval of the Forecast Chapter of the Airport Master Plan and completed the Facility Requirements Section. The Airport is now moving forward into the Alternatives Section of the process. This puts the entire project at about 60% completion. The Alternatives section is one of the longer sections to complete during this process.

The Master Plan Advisory Committee will meet again during the month of August. Shortly following that meeting the Airport will advertise for the public outreach meeting. That meeting will most likely occur in late August.

Should you wish to review more detailed information on the project or provide comments to the Master Plan process please visit the website dedicated to the Airport's Master Plan:

<http://lmtmasterplan.com>

From the website you can use the contact form to reach out the Master Plan team for any questions or comments. You can also sign up to receive updates as they are published to the website.

Work on the Taxiway Golf project is scheduled to begin on Monday July 22, 2019. Rocky Mountain Construction will begin construction activity in Work Areas 5 and 6. This will include milling 4" of pavement from TWY Delta between the ARFF Station and RWY 7/25 and replacing with new asphalt. Pacific Electric will be running new airfield lighting cables from the ARFF station to the airfield electrical vault. Work in these areas is scheduled to be completed on Thursday August 1, 2019. The following closures will be in place during this period:

Runway 7/25
TWY Foxtrot west of TWY Golf
TWY Delta between the ANG Fuel Barn and RWY 7/25

Starting Friday August 2, 2019 Rocky Mountain Construction will transition to Work Area 4. Work Area 4 includes the pavement between TWY Echo and RWY 7/25. This is the most intensive phase of the project as the pavement in this area is in the worst shape. On the northern portion of this work area all of the current pavement will be removed, and the existing base material reconditioned prior to the installation of new asphalt pavement. In the intersection of TWY Golf and TWY Foxtrot the existing pavement and base material will be completely removed, and a new intersection will be constructed. Underdrains, new airfield electrical cable, and LED taxiway edge lights and signs will be installed during this time. Work in this area is expected to last until late September. The following closures will be in place during this period:

TWY Golf between TWY Echo and RWY 7/25
TWY Foxtrot between RWY 14/32 and TWY Delta

After completing work in Work Area 4 Rocky Mountain Construction will then move to Work Area 3. Work Area 3 consists of the runway safety area where TWY Golf crosses RWY 7/25. Given the reconstruction project for RWY 7/25 in 2022 no pavement work will occur in this area. The work to take place in this area includes underdrains, new electrical cabling, and new airfield lighting and signage. The following closures will be in place during this period:

RWY 7/25
TWY Golf between RWY 7/25 and TWY Kilo

With the above work slated to be complete in mid to late October it is highly likely that the remainder of the project will be postponed until next construction season due to weather related limitations on construction activity in the Klamath Basin in late fall. Starting mid spring the project will resume and complete the rehabilitation work on Taxiway Golf south of RWY 7/25.

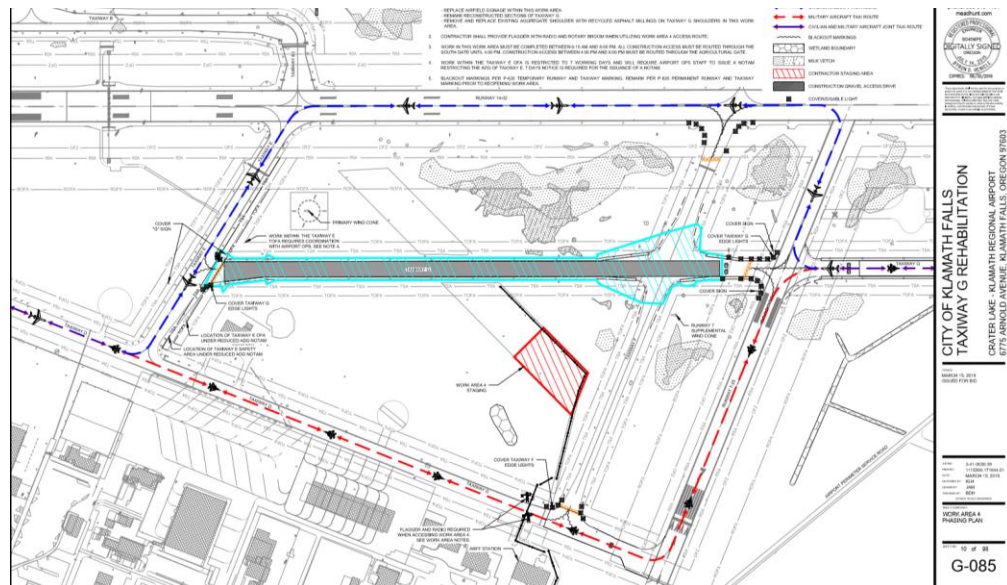
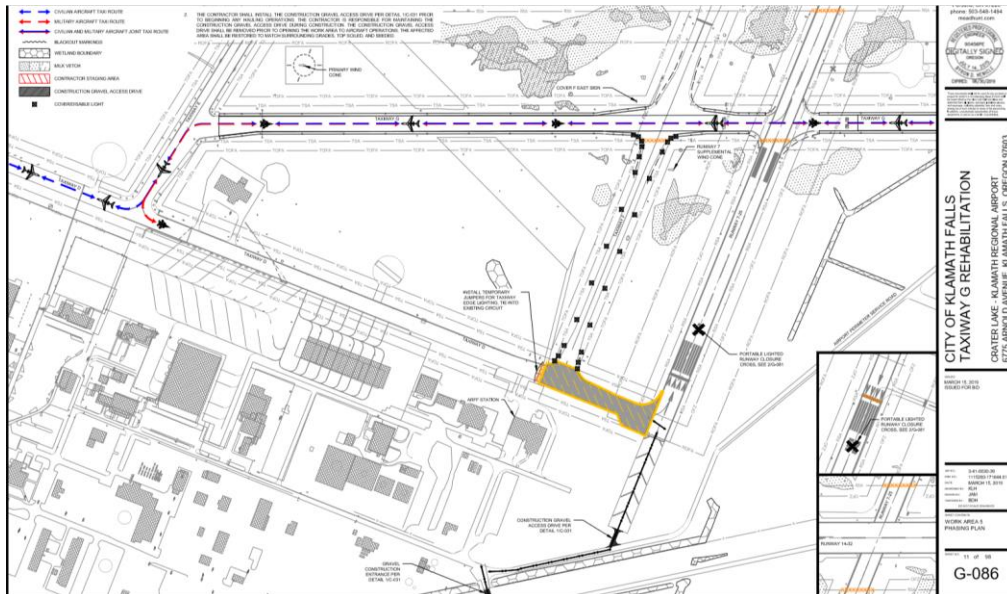

HANGAR INSPECTIONS

The Airport Administration Office recently completed the hangar inspection process as required by the Federal Aviation Administration. The results of the inspection were overwhelmingly positive. The Airport would like to thank each and every tenant for ensuring standards are met and continuing to foster a professional and energetic image for the Airport.

If you have not scheduled a hangar inspection, please contact the Airport Administration Office as soon as practical. The Hangar Inspection checklist is included as Appendix A of the Airport's Rules and Regulations.

RUNWAY 7/25 PAINTING

The Crater Lake – Klamath Regional Airport has a paint marking rehabilitation plan in place. All the markings on the Airport are phased for rehab over a 4-year period. This summer Runway 7/25 will be painted. As part of this project a vast majority of the current markings will be removed prior to being repainted. While no date has officially been set, this work will likely take place in late August or early September. Runway 7/25 will need to be closed for a couple of days to facilitate this work. As part of this project the contractor will also perform rubber removal on a 24,000 sq. ft. area on the approach end of Runway 32.

AIRPORT CERTIFICATION INSPECTION

The Airport is scheduled for its annual certification inspection Monday August 19 through Wednesday August 21.

FUTURE AIRPORT PROJECTS

2019 = Rehab Taxiway Golf

2020 = Rehab TWY B1 and TWY Delta

2022 = Reconstruct Runway 7/25

2024 = Reconstruct Taxiway Foxtrot

GENERAL AVIATION CRACK SEAL WORK

Each summer the Airport undertakes a crack seal project to ensure longevity of our pavement surfaces. This summer the General Aviation ramps are due for crack seal. Musser Sealcoat and Striping Inc. was selected as the contractor for this year's project. Crews will be on-site from Monday August 19 to Wednesday August 29 from 08:00L to 18:00L each workday. No work will take place on the weekends. All asphalt portions of the West General Aviation Ramps will be crack sealed. After application the material can be driven over within an hour.

AIRPORT HANGAR PARTY

Wednesday August 7, 2019

11:00L to 13:00L

Airport Operations Building

Burgers, Hot Dogs, Condiments, and Chips will be provided by the Airport. Please bring your own chair as desired and your own non-alcoholic beverages.

AIRPORT TRIVIA

1. How many tons of asphalt are being used on the Taxiway Golf project?
 - a. 9,375
 - b. 12,325
 - c. 17,180
 - d. 22,950
2. How many taxiway edge lights are incorporated in the Taxiway Golf project?
 - a. 112
 - b. 125
 - c. 205
 - d. 250
3. How many feet of underdrain is the Airport installing for the Taxiway Golf project?
 - a. 5,800
 - b. 8,800
 - c. 12,530
 - d. 17,600

Answers: 1 = D 2 = B 3 = C